



# National Committee on Uniform Traffic Control Devices

13236 North 7th Street, Suite 4-259, Phoenix, Arizona 85022  
Phone/Text: 231-4-NCUTCD (231-462-8823)  
E-mail: secretary@ncutcd.org Website: <https://ncutcd.org>

Item No.: 24A-TTC-03  
Technical Correction

## NCUTCD PROPOSAL FOR CHANGES TO THE MANUAL ON UNIFORM TRAFFIC CONTROL DEVICES

**COMMITTEE / TASK FORCE:** Temporary Traffic Control TC  
**ITEM NUMBER:** 24A-TTC-03  
**TOPIC:** Technical Correction –Remove North Arrows from Part 6 Figures  
**ORIGIN OF REQUEST:** TTC Technical Committee  
**AFFECTED SECTIONS OF MUTCD:**

- Section 6B.03 Components of Temporary Traffic Control Zones (Figure 6B-1)
- Section 6B.06 Activity Area (Figure 6B-2)
- Section 6B.08 Tapers (Figure 6B-3)
- Section 6L.03 STOP/SLOW Automated Flagger Assistance Devices (Figure 6L-1)
- Section 6L.04 Red/Yellow Lens Automated Flagger Assistance Devices (Figure 6L-2)
- Section 6N.19 Late Merge (Figure 6N-1)
- Section 6P.01 Typical Applications (Figures 6P-1 through 6P-54)

### DEVELOPMENT HISTORY:

Approved by TTC: 01/11/2024  
Approved by NCUTCD Council: 06/27/2024

*This is a proposal for recommended changes to the MUTCD that has been approved by the NCUTCD Council. This proposal does not represent a revision of the MUTCD and does not constitute official MUTCD standards, guidance, or options. It will be submitted to FHWA for consideration for inclusion in a future MUTCD revision. The MUTCD can be revised only through the federal rulemaking process.*

### SUMMARY:

Proposing technical correction to several figures in Part 6 to remove North Arrows. Covers Figures 6B-1, 6B-2, and 6B-3 in Chapter 6B; Figures 6L-1 and 6L-2 in Chapter 6L; Figure 6N-1 in Chapter 6N; and Figures 6P-1 (Typical Application 1) through 6P-54 (Typical Application 54) in Chapter 6P. All of the noted Figures and Typical Applications (TA-1 through TA-54) show North Arrows that were not part of the original NPA and appears to now be “new content”.

25 **DISCUSSION:**

26 A north arrow has been added to Figures 6B-1, 6B-2, and 6B-3 in Chapter 6B; Figures 6L-1 and  
27 6L-in Chapter 6L; Figure 6N-1 in Chapter 6N; and Figures 6P-1 (Typical Application 1) through  
28 6P-54 (Typical Application 54) in Chapter 6P, without public review. The affected typical  
29 application applies to all roadways not just northbound travel on roadways with a north-south  
30 configuration. The 11th Edition introduced North Arrows on all of the Typical Application figures  
31 that are contained in Chapter 6P, Typical Application, however this was not included as part of  
32 the NPA and is new content.

33  
34 MUTCD Typical Application (TA) figures are meant to represent common Temporary Traffic  
35 Control (TTC) scenarios that may be applied along any roadway regardless of traffic or geo-  
36 magnetically direction (i.e. north, east, south and west). North Arrows are typically placed along  
37 plan sets that have geographical references such as Latitude and Longitude. North Arrows on a  
38 TA may confuse the end users in the field allowing them to assume that they may only be able  
39 to use any of the MUTCD TAs if they are working along a roadway in the northbound direction  
40 leaving them to believe that they cannot use the TA for any other directional roadway.  
41

42 **RECOMMENDED MUTCD CHANGES:**

43 The following present the proposed changes to the current MUTCD within the context of the  
44 current MUTCD language. Proposed additions to the MUTCD are shown in blue underline and  
45 proposed deletions from the MUTCD are shown in ~~red strikethrough~~. Changes previously  
46 approved by NCUTCD Council (but not yet adopted by FHWA) are shown in green double  
47 underline for additions and ~~green double strikethrough~~ for deletions. In some cases,  
48 background comments may be provided with the MUTCD text. These comments are indicated  
49 by [bracketed white text in shaded green].

50  
51  
52  
53  
54  
55  
56

**PART 6 TEMPORARY TRAFFIC CONTROL**  
**CHAPTER 6P. TYPICAL APPLICATIONS**

**Section 6P.01 Typical Applications**

[The following is an example of the North Arrow removal recommendation. The recommendation applies to Figures 6B-1 through 6B-3, 6L-1 and 6L-2, 6N-1, and 6P-1 through 6P-54.]

MUTCD 11th Edition

Page 861

**Figure 6P-1. Work Beyond the Shoulder (TA-1)**

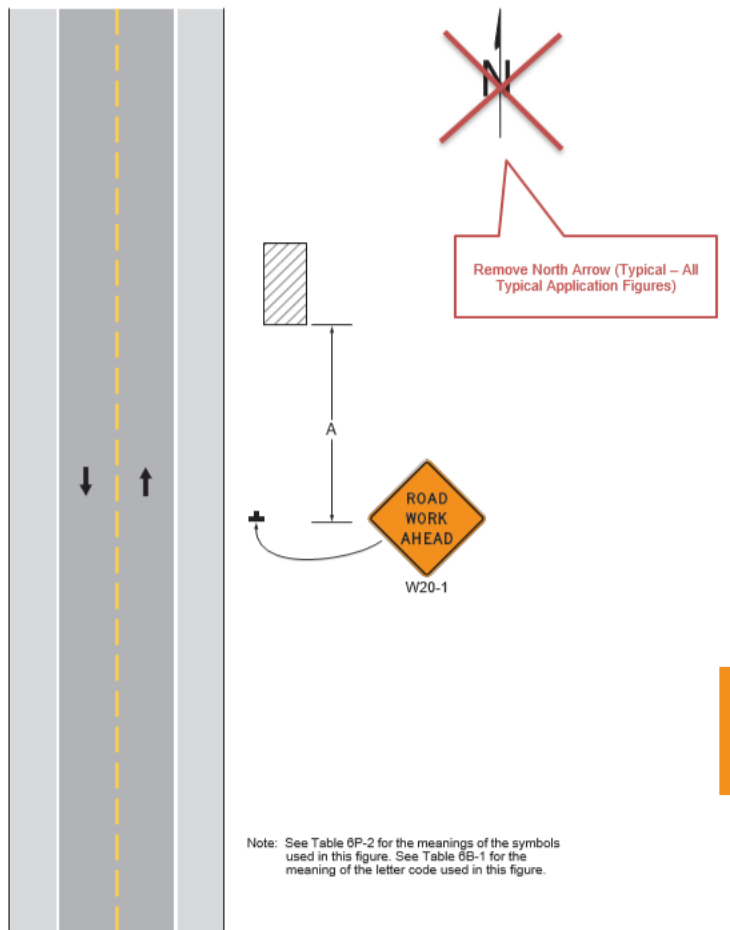

**Typical Application 1**

57