



National Committee on Uniform Traffic Control Devices

13236 North 7th Street, Suite 4-259, Phoenix, Arizona 85022
Phone/Text: 231-4-NCUTCD (231-462-8823)
E-mail: secretary@ncutcd.org Website: <https://ncutcd.org>

Item No.: 24B-TTC-07

NCUTCD PROPOSAL FOR CHANGES TO THE MANUAL ON UNIFORM TRAFFIC CONTROL DEVICES

COMMITTEE / TASK FORCE: Temporary Traffic Control Technical Committee
ITEM NUMBER: 24B-TTC-07
TOPIC: Center / Bike Lane Closed Warning Sign
ORIGIN OF REQUEST: TTC review of 11th Edition
AFFECTED SECTIONS OF MUTCD: 6H.07

DEVELOPMENT HISTORY:

Approved by TTC: 06/27/2024
Approved by NCUTCD Council:

This is a proposal for recommended changes to the MUTCD that has been developed by a technical committee or joint task force of the NCUTCD. The NCUTCD is distributing it to its sponsoring organizations for review and comment. Sponsor comments will be considered in revising the proposal prior to NCUTCD Council consideration. This proposal does not represent a revision of the MUTCD and does not constitute official MUTCD standards, guidance, or options. If approved by the NCUTCD Council, the recommended changes will be submitted to FHWA for consideration for inclusion in a future MUTCD revision. The MUTCD can be revised only through the federal rulemaking process.

SUMMARY:

In the MUTCD 11th Edition, the W9-3 sign is a symbol sign illustrating a center lane closed ahead. This symbol sign replaced the CENTER LANE CLOSED AHEAD W9-3 word legend sign from the 2009 MUTCD. The proposed changes will revive the word message sign CENTER LANE CLOSED AHEAD as a version of the W20-5 sign which is allowed in the FHWA Standard Highway Signs book. Also, in Typical Applications a new sign "BIKE LANE CLOSED AHEAD" (W20-5b) was introduced. Upon inspection of the current 2023 11th edition, TTC recommends that the policy contained in Section 6H.07 be changed to reflect changes occurred in 11th edition graphically.

DISCUSSION:

In the 2003 MUTCD, the W9-3 sign was the word legend warning sign CENTER LANE CLOSED AHEAD and the W9-3a sign was a symbol warning sign illustrating a center lane closed ahead. In the 2009 MUTCD, the W9-3a symbol sign was deleted. The CENTER LANE CLOSED AHEAD (W9-3) sign was the only available sign for Manual users. In the 11th Edition of MUTCD the symbol sign W9-3 (same as 2003 W9-3a sign) was shown in place of W9-3 word

36 legend sign. The proposed changes will revive the word message sign CENTER LANE
37 CLOSED AHEAD as a version of the W20-5 sign. The Temporary Traffic Committee has
38 reviewed the current sign guidance and has determined that there are situations where a
39 symbol indicating a lane closed is appropriate, but there may also be situations or conditions
40 that guidance with words is more appropriate than the symbol. The NCUTCD recommended
41 similar action to FHWA in comments on the 11th Edition NPA, but it was not implemented. The
42 TTC Technical Committee has refined the proposed change to add to the guidance for the
43 W20-5 warning sign where the sign legend can be RIGHT, or LEFT, or CENTER LANE
44 CLOSED. The 2004 *Standard Highway Signs* (SHS) publication and 2012 SHS Supplement
45 show this as an option. The page from the 2012 SHS Supplement is included as information
46 only at the end of this document.

47
48 Secondly, in 11th edition of the MUTCD, Figures 6H-1, 6P-47, and 6P-48 have introduced a
49 new “BIKE LANE CLOSED AHEAD” (W20-5b) warning sign. However, no guidance is given in
50 Chapter 6H for using the new sign. The Temporary Traffic Committee proposes that the sign be
51 added to Section 6H.07.

52
53 **RECOMMENDED MUTCD CHANGES:**
54 The following present the proposed changes to the current MUTCD within the context of the
55 current MUTCD language. Proposed additions to the MUTCD are shown in blue underline and
56 proposed deletions from the MUTCD are shown in ~~red strikethrough~~. Changes previously
57 approved by NCUTCD Council (but not yet adopted by FHWA) are shown in green double
58 underline for additions and ~~green double strikethrough~~ for deletions. In some cases,
59 background comments may be provided with the MUTCD text. These comments are indicated
60 by bracketed white text in shaded green. Deletions made by a technical committee or task
61 force after initial distribution to sponsoring organizations are shown in ~~highlighted red~~
62 ~~strikethrough and Helvetica text~~. Additions made by a technical committee or task force after
63 initial distribution to sponsoring organizations are shown in underline blue and Helvetica text.

PART 6 TEMPORARY TRAFFIC CONTROL

CHAPTER 6H. TTC ZONE WARNING SIGNS

Table 6H-1. Temporary Traffic Control Zone Warning Sign and Plaque Sizes (Sheet 2 of 2)

[Only a few sample lines of Table 6H-1 shown.]

Sign or Plaque	Sign Designation	Section	Conventional Road	Freeway or Expressway	Minimum
Lane(s) Closed (with distance)	W20-5, 5a	6H.07	36x36	48x48	30x30
Bike Lane Closed (with distance)	W20-5b	6P.01 6H.07	36x36	-	30x30

Section 6H.07 Lane(s) Closed Signs (W20-5, W20-5a, [W20-5b](#), and W9-3)

Standard:

01 The Lane(s) Closed sign (see Figure 6H-1) shall be used in advance of that point where one or more through lanes of a multi-lane roadway are closed.

02 For a single lane closure, the Lane Closed (W20-5) sign (see Figure 6H-1) shall use the legend RIGHT (LEFT, [CENTER](#)) LANE CLOSED. Where two or more adjacent lanes are closed, the W20-5a sign (see Figure 6H-1) shall use the legend XX RIGHT (LEFT, [CENTER](#)) LANES CLOSED.

02a [The BIKE LANE CLOSED \(W20-5b\) sign \(see Figure 6H-1\) shall be used in advance of that point where bike lane is closed.](#)

Option:

03 The distance legend may be either XX FEET, XX MILES, or AHEAD.

Guidance:

04 The Interior Lane Shift (W9-3) sign (see Figure 6H-1) should be used in advance of that point where work occupies an interior lane(s) and approaching motor vehicle traffic is directed to the right or left of the work zone in the lane(s) by using a shifting taper to route traffic around the closed interior lane(s).

90 [The following page from the Standard Highway Signs (SHS) Publication is included for information
 91 only to show that CENTER LANE is an option used on the W20-5 sign.]

W20-5
 Revised 3/1/2012

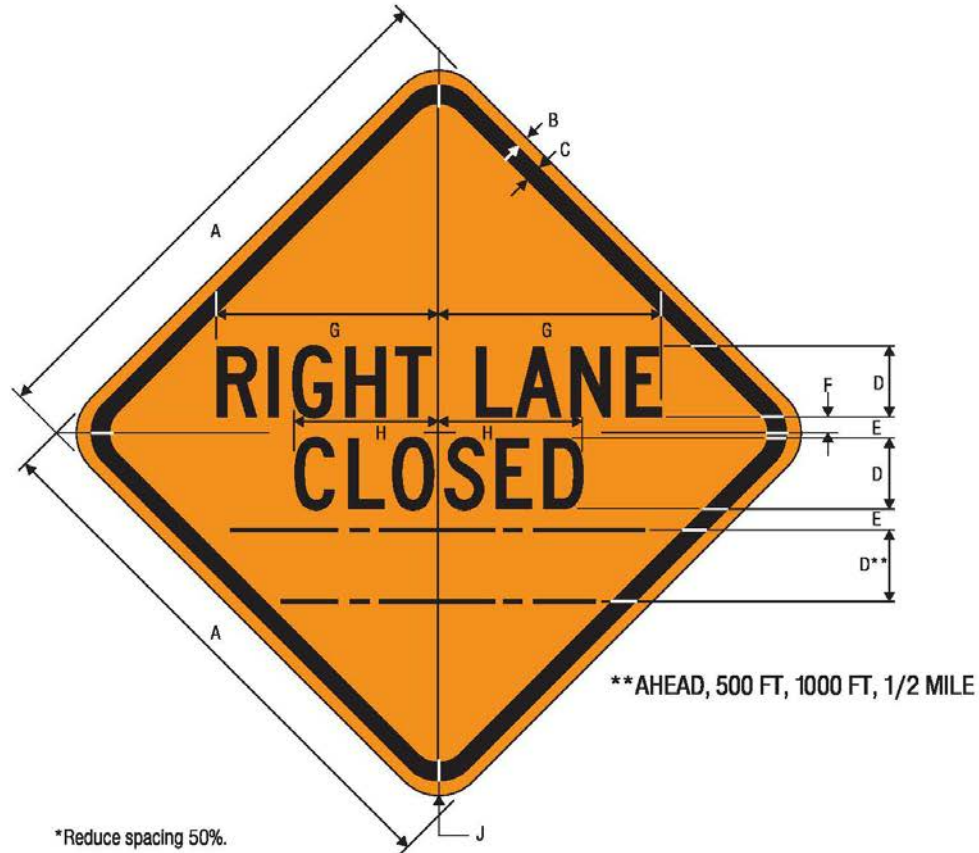

*Reduce spacing 50%.

**AHEAD, 500 FT, 1000 FT, 1/2 MILE

W20-5

RIGHT (CENTER) (LEFT) LANE CLOSED



A	B	C	D	E	F	G	H	J	K	L	M
30	.5	.75	4 C	1.625	2	12.614	8.203	1.875	11.604	13.420	13.280
36	.625	.875	5 C*	2.75	.375	15.75	10.25	2.25	14.5	16.25	15.75
48	.75	1.25	6 C*	3.375	.5	19	12.313	3	17.438	20.375	19.375

COLORS: LEGEND, BORDER — BLACK
 BACKGROUND — ORANGE (RETROREFLECTIVE)

92